

7066 CATCH BASIN CURB INLET

Heavy duty
 With 7045 Type M1 grate and 7060 T1 back
 Approximate 195 sq. in. open area
 Accepts 7045 grates
 Special lettered grate
 "DUMP NO WASTE!" lettering
 and fish image

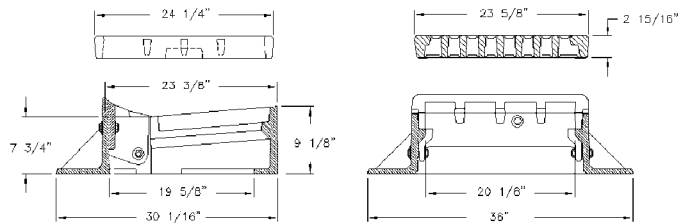

Options
 Accepts 7050 backs



7075 CATCH BASIN CURB INLET

Heavy duty
 With Type 7075 M1 grate
 Approximate 240 sq. in. open area
 With 7070 frame & back
 Accepts 7076 grates

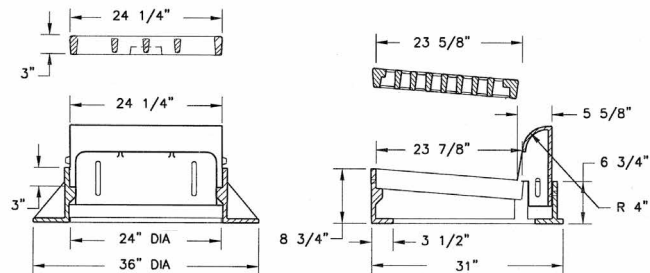

Supplied By:

**TRENCHDRAIN
 SUPPLY**

877-903-7246

www.trenchdrainsupply.com